

Dear SMD 27 students,

I know you are just beginning to enjoy a well-deserved holiday break. However, I need to relay some important information to you about the Musculoskeletal/Integument System (MSI) that begins Tuesday, January 2<sup>nd</sup>. As you are aware, MSI is unique system because it is your first experience with the anatomy curriculum, which involves cadaver dissection.

To be prepared for the MSI System and dissection in the anatomy lab, you need to complete a few more tasks, purchase some supplies, and download software. The following list includes the tasks you must complete by designated deadline dates. **Failure to complete these tasks means you will not be able to participate in the mandatory introductory lab on January 2<sup>nd</sup>.**

1. **COMPLETED: November 6<sup>th</sup>:** ~~Formaldehyde Exposure & Respiratory Protection in Gross Anatomy.~~ Thank you!
2. **DEADLINE: January 1<sup>st</sup>:** Read the Gross Anatomy Laboratory Policies and Rules document attached to the email, which can also be located on the online anatomy lab manual: (anatomylab.class.virginia.edu). To acknowledge that you have read, understand, and will abide by the rules in the Gross Anatomy Laboratory Policies and Rules document, please go to the following Qualtrics Survey page to submit an electronic signature: [https://virginia.az1.qualtrics.com/jfe/form/SV\\_4YCGCJ6gN7Al8fr](https://virginia.az1.qualtrics.com/jfe/form/SV_4YCGCJ6gN7Al8fr). On the first day of lab, you will complete a short (fun) quiz covering the lab policies and rules and won't be able to move on to more exciting lab activities until your dissection team scores a 100%.
3. **DEADLINE: January 1<sup>st</sup>: Know your schedule.** To reduce the number of students in the lab during COVID, we successfully used the afternoons to schedule lab sessions. Because of that success, the administration is allowing us to schedule afternoon labs to more efficiently use our allocated time. **Since afternoon scheduling will be something new to you, make sure you know your afternoon lab dates before you schedule other events.**
4. **DEADLINE: January 1<sup>st</sup>:** Access the locker assignments posted to the online anatomy lab manual (anatomylab.class.virginia.edu) to identify your locker number. To protect your privacy on the open website, viewing the locker assignments requires a password, which is in the email from me introducing this letter. **You aren't required to change into/out of scrubs in the locker room before and after labs, but if you need to change, you may use the locker room to do so.** The locker will be assigned to you until you complete your second year of medical school. You are welcome to place a padlock on your locker, but please don't do so until January 2<sup>nd</sup>.

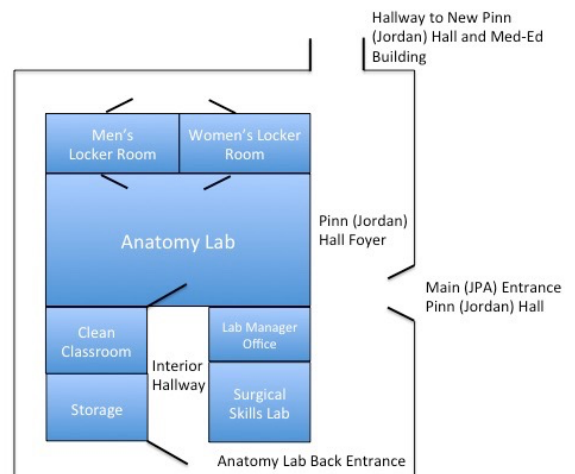

5. **DEADLINE: January 1<sup>st</sup>:** The online anatomy lab manual ([anatomylab.class.virginia.edu](http://anatomylab.class.virginia.edu)) has a listing of the required attire, required/recommended textbooks, and recommended resources for anatomy lab. For your convenience, the required attire for the first day of lab is listed below.

- **Scrubs:** A dedicated pair of scrubs to wear in the lab is required when dissecting cadavers or viewing pro-sections.
- **Protective eyewear:** Eye protection must be worn whenever you are in the dissection lab. Regular prescription eyeglasses are sufficient eye protection. **We provide you one plastic rim onto which a disposable plastic eye shield is attached. The rim and attached eye shield should be stored in your locker.** When the replaceable eye shield is worn out from scratches, we will have replacements in a drawer near the sinks in the lab. **However, we suggest that you provide your own eye high quality eye protection.** [Stoggles](#) are comfortable, stylish, and reasonably-priced protective eyewear commonly purchased by students prior to the start of clerkship. I suggest purchasing them now!
- **Close-toed shoes:** Most students “sacrifice” an old pair of shoes/sneakers for use only in the anatomy lab. We suggest that students store these dedicated shoes in their locker in the anatomy lab locker room. If you dedicate a pair of shoes for only lab use, you aren’t required to wear shoe covers in the lab, which prevents unnecessary waste. **Sandals or open-toed shoes are NEVER to be worn in the lab.**

6. **DEADLINE January 2<sup>nd</sup>:** An innovation we integrated into our anatomy curriculum a few years ago is the award-winning software program Complete Anatomy. It is a powerful anatomy program that allows you to interact with a 3D anatomical model. Virtual dissections created using this software are embedded in your anatomy resources (PowerPoint Handouts). If you have the software, you will be able to interact with the “dissections” as an interactive 3D model. **I am pleased to announce that the School of Medicine is purchasing Complete Anatomy access for you until December of 2026!** The instructions for download and access code are posted on the anatomy website at the bottom left of the homepage. **The email accompanying this letter provides the password to access the download instructions.**

Sincerely,

Dr. David G. Moyer  
Assistant Professor of Medical Education  
Director of Gross Anatomy Education  
Co-director Surgical Skills Training Center